



2 Charter Place, Witney OX28 4BR

Draft details - may be subject to alterations.

A very appealing 2 bedroom ground floor apartment, forming part of this Grade 2 listed building converted by Beechcroft in 2006. The property has a stunning position on Church Green with a view across the green and St Mary's Church. Spacious accommodation includes an entrance hall leading to a large living/dining room with a bay window, a kitchen with appliances, 2 bedrooms, an ensuite shower to the master bedroom, a main bathroom and a useful second bedroom, currently used as a study, plus gas central heating. The property has the additional benefit of allocated parking and a mature communal garden. Available for sale with no onward chain.

THOMAS
MERRIFIELD

SALES LETTINGS

e. witney@thomasmerrifield.co.uk

t. 01993 772000

Offers in Excess of £350,000

www.thomasmerrifield.co.uk



2 Charter Place, Witney OX28 4BR

- Entrance Hall
- Living/Dining Room
- Kitchen
- 2 Bedrooms
- Ensuite & Main Bathroom
- Gas Central Heating
- Allocated Parking
- Communal Gardens
- Prime Town Centre Location
- No Onward Chain

Directions

From our office in Market Square proceed along Church Green. Charter Place is found after a short distance on the right hand side. 26J23

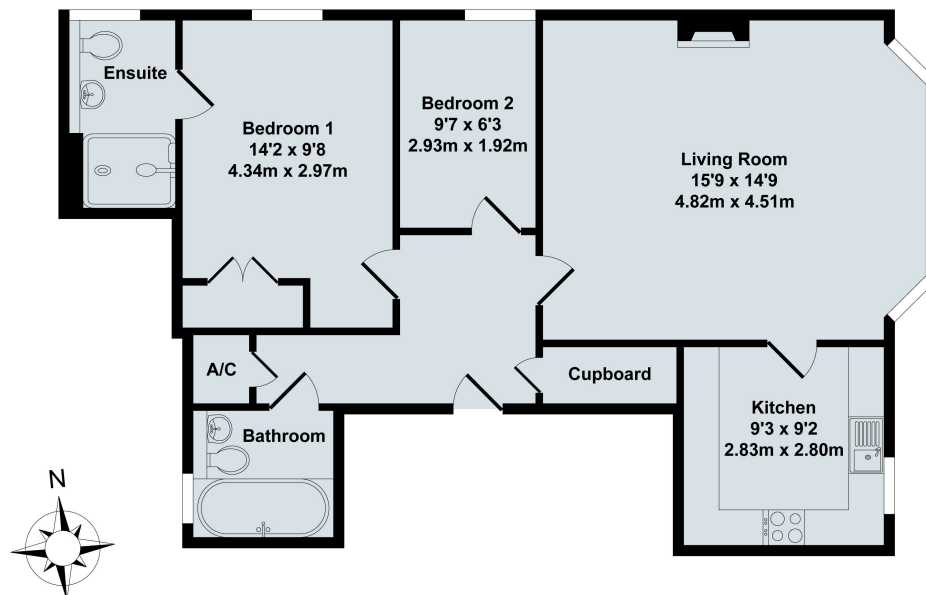

2 Charter Place, Witney

Total Approx. Floor Area 743 Sq.Ft. (69.08 Sq.M.)

All items illustrated on this plan are included in the "Total Approx Floor Area"

Local Authority:

WODC Band D

Contact:

52 Market Square, Witney,
Oxfordshire, OX28 6AF

Tenure:

Leasehold - 999 years from 2006. (2023) Service Charge:
£4469.17 per annum. (2023) Ground Rent: £250 per annum

Tel: 01993 772000

Email: witney@thomasmerrifield.co.uk

Important Notice

Thomas Merrifield for themselves and their clients give notice that:-

1. They are not authorised to make or give representation or warranty in relation to this property, either on their own behalf or on behalf of the Seller. They assume no responsibility for any statement made in these particulars. These particulars do not form part of any offer or contract and must not be relied upon as statements or representations of fact.
2. Whilst every attempt has been made to ensure the accuracy of the floorplan contained here, measurements of doors, windows, rooms and any other items are approximate and no responsibility is taken for any error, omission, or mis- statement.
3. All areas, measurements or distances are approximate. The particulars are intended for guidance only and are not necessarily comprehensive. A wide angle lens may have been used in photography. Thomas Merrifield have not tested appliances or services and it should not be assumed that the property has all necessary planning, building regulation and other consents. Buyers must satisfy themselves with the property by inspection or otherwise.
4. Reference to any mechanical or electrical equipment does not constitute a representation that such equipment is capable of fulfilling its function and prospective Buyers must make their own enquiries.
5. They have no responsibility for any expenses or costs incurred by prospective Buyers in inspecting properties which have been sold, let or withdrawn. Applicants are advised to contact the Agent to check availability and any other information of particular importance to them, prior to inspecting the property, particularly if travelling some distance.